

Incremental encoders

Through hollow shaft $\varnothing 12$ -26 mm or cone shaft $\varnothing 17$ mm

250...2500 pulses per revolution

HOG 75



HOG 75

Technical data - electrical ratings

Voltage supply	9...26 VDC 5 VDC ± 5 %
Consumption w/o load	≤ 100 mA
Pulses per revolution	250...2500
Phase shift	$90^\circ \pm 20^\circ$
Scan ratio	40...60 %
Reference signal	Zero pulse, width 90°
Sensing method	Optical
Output frequency	≤ 120 kHz
Output signals	K1, K2, K0 + inverted
Output stages	HTL TTL/RS422
Interference immunity	EN 61000-6-2
Emitted interference	EN 61000-6-3
Approvals	CE, UL approval / E256710

Features

- Through hollow shaft $\varnothing 12$...26 mm or cone shaft $\varnothing 17$ mm (1:10)
- Optical sensing method
- Compact, robust aluminium housing
- Inside connecting terminals
- Output stage HTL or TTL
- Output stage TTL with regulator UB 9...26 VDC
- Especially high resistance to vibrations
- Protection against inductive shaft current by hybrid bearings (HOG 75 C, HOG 75 KC)

Technical data - mechanical design

Size (flange)	$\varnothing 75$ mm
Shaft loading	≤ 80 N axial ≤ 150 N radial
Protection DIN EN 60529	IP 56
Starting torque	≤ 4 Ncm
Rotor moment of inertia	180 gcm ²
Materials	Housing: aluminium Shaft: stainless steel
Operating temperature	-30 ... $+85$ °C
Resistance	IEC 60068-2-6 Vibration 48 g, 10-2000 Hz IEC 60068-2-27 Shock 200 g, 6 ms
Explosion protection	II 3 G Ex nA IIC T4 Gc (gas) II 3 D Ex tc IIIB T85°C Dc (dust)
Connection	Connecting terminal

HOG 75

Shaft type	$\varnothing 12$...26 mm (through hollow shaft)
Operating speed	≤ 10000 rpm (mechanical)
Weight approx.	580 g

HOG 75 K

Shaft type	$\varnothing 17$ mm (cone shaft 1:10)
Operating speed	≤ 12000 rpm (mechanical)
Weight approx.	860 g

Incremental encoders

Through hollow shaft \varnothing 12-26 mm or cone shaft \varnothing 17 mm

250...2500 pulses per revolution

HOG 75

Part number

Incremental encoder with through hollow shaft

HOG 75 DN

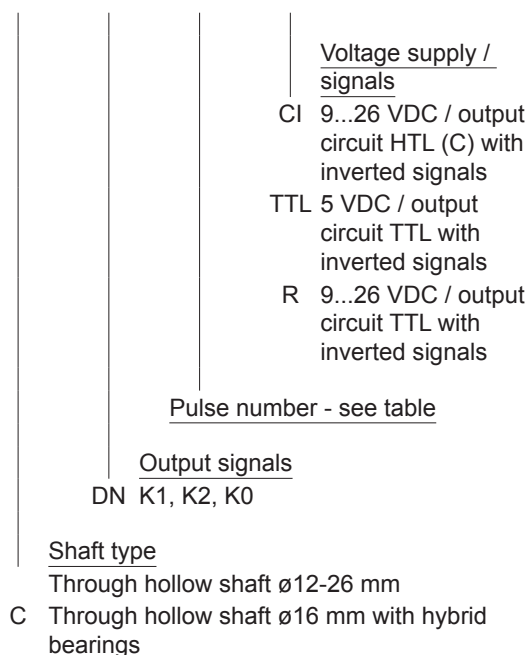

Incremental encoder with cone shaft

HOG 75 K C DN

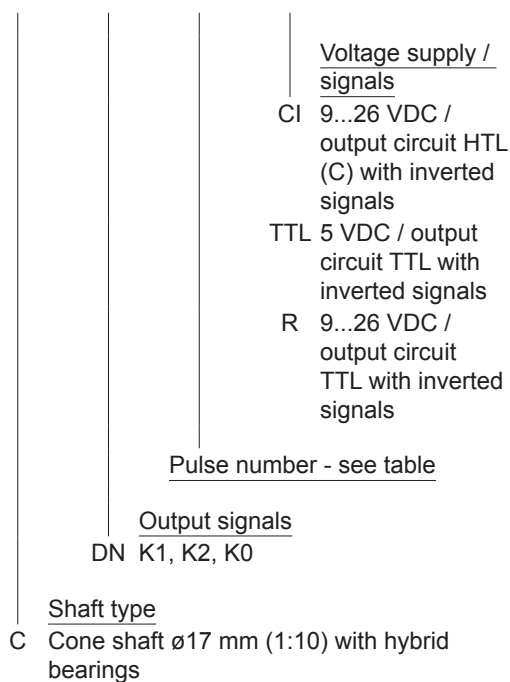

Pulse number

250	500	720	1200	2048
256	512	1024	1250	2500

Other pulse numbers on request.

Accessories

Connectors and cables

HEK 8 Sensor cable for encoders

Diagnostic accessories

HENQ 1100 Analyzer for encoders

Incremental encoders

Through hollow shaft $\varnothing 12-26$ mm or cone shaft $\varnothing 17$ mm

250...2500 pulses per revolution

HOG 75

Output signals

At positive rotating direction

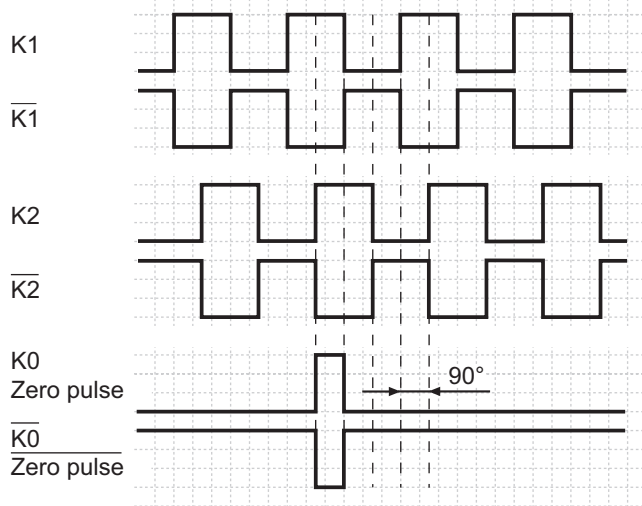

Terminal assignment

View A - Connecting terminal

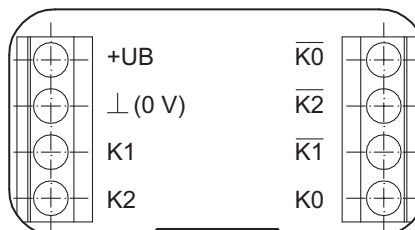

Incremental encoders

Through hollow shaft $\varnothing 12-26$ mm or cone shaft $\varnothing 17$ mm
250...2500 pulses per revolution

HOG 75

Dimensions

HOG 75 - With through hollow shaft without hybrid bearings

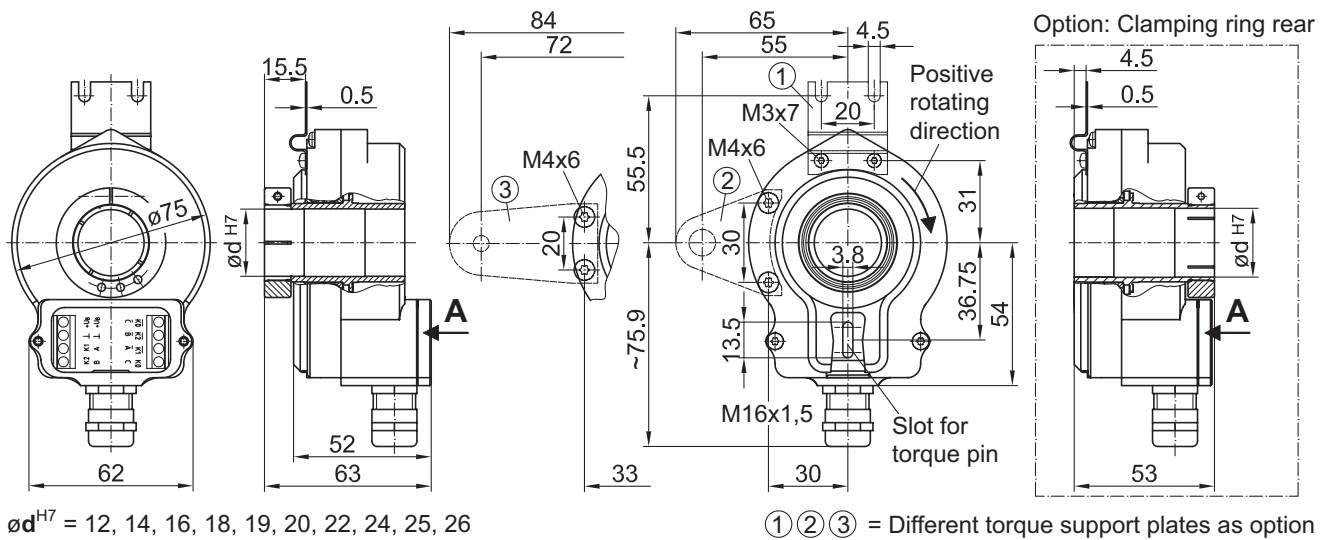

$\varnothing d^{H7} = 12, 14, 16, 18, 19, 20, 22, 24, 25, 26$

HOG 75 C - With through hollow shaft and hybrid bearings

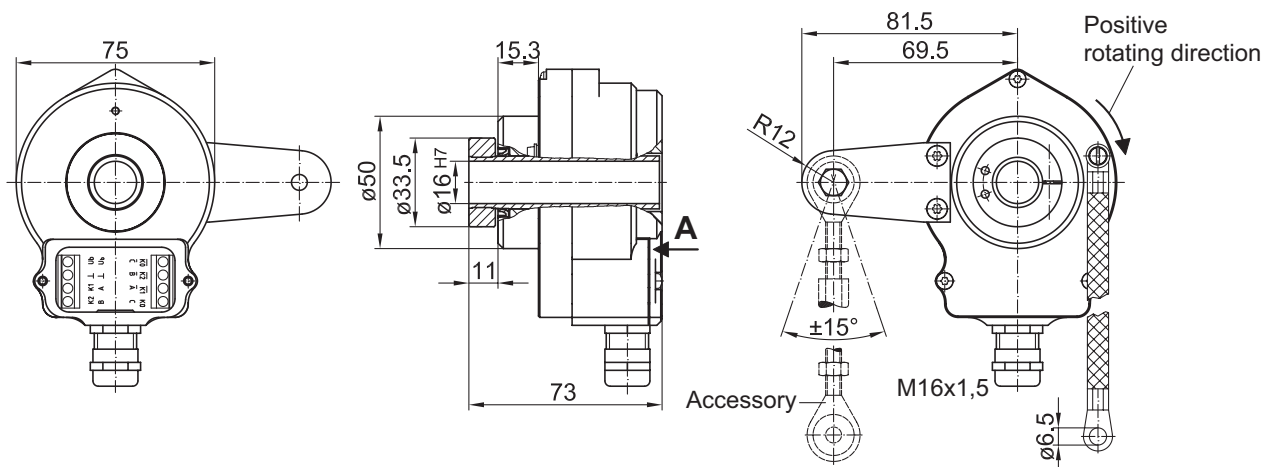

HOG 75 KC - With cone shaft and hybrid bearings

